

Assemble

How to insert the SD card :

Please insert SD card with right direction

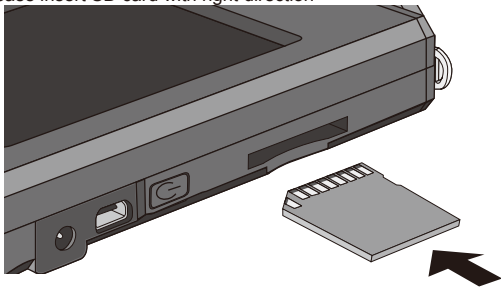

How to tie string :

step1.Remove strap holder
step2.Tie string at holder side
step3.Tie string at sensor cover side
step4.Install strap holder back

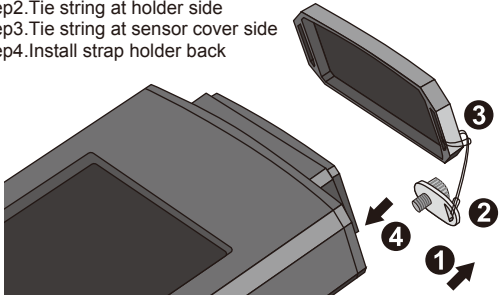

Physical Description

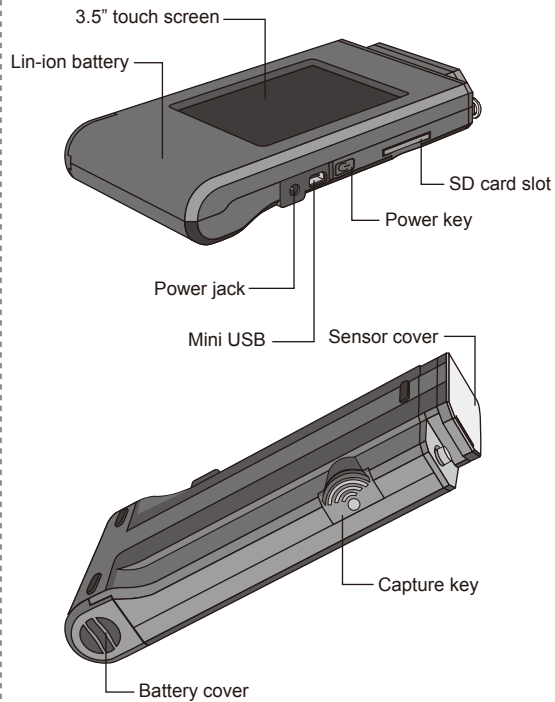

SPECTURM MK350 MANUAL

Accessory - 1

How to install Li-ion Battery :

step1. Remove battery cover
step2. Install Li-ion battery with right direction (please see index)
step3. Put battery cover back

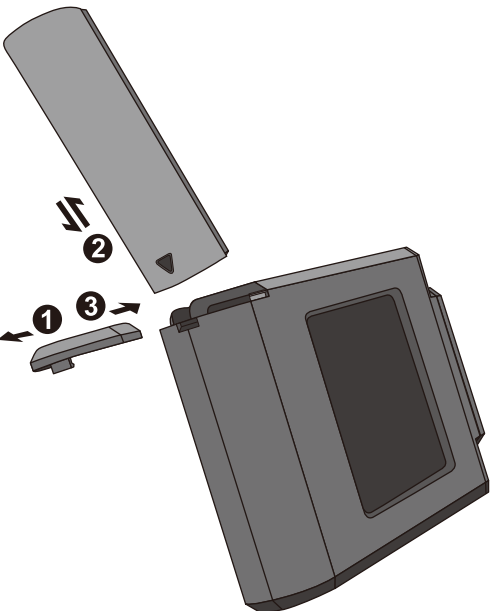

Accessory - 2

How to charge power :

Please plug AC adaptor into power jack

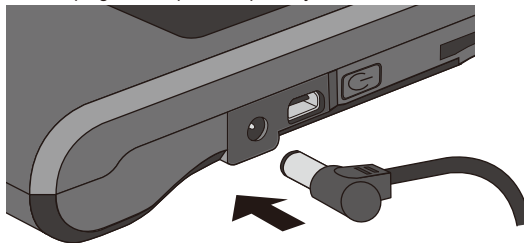

How to transfer your data :

1. Please connect mini USB cable to your PC
2. MK350 saves raw data only
3. Support mass storage

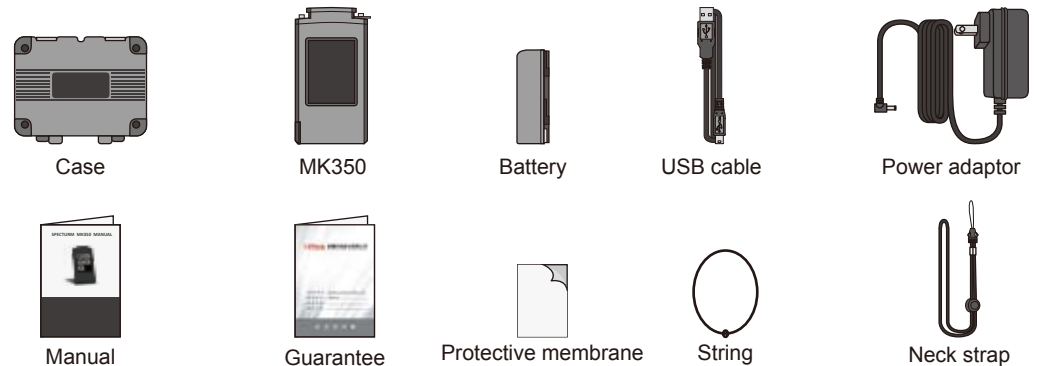
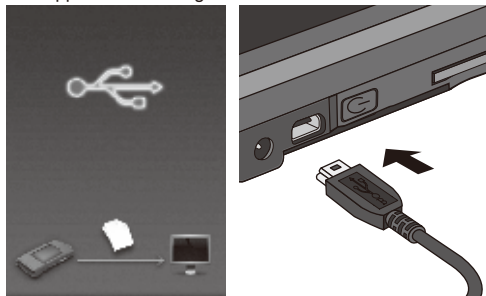

SPECIFICATION

Spectral Resolution	12 nm
Wavelength Range	340 ~ 750 nm
Digital Resolution	16 bits
LCD	3.5 inch (320x240) with TouchScreen
Interface	USB,SD
Battery	Rechargeable Li-ion battery
Dimension	144.2 x 78.0 x 24.0 mm
Weight (including battery)	200g
Measurement Capabilities	Luminance, chromaticity, emission, dominant wavelength, correlated color temperature, color rendering index.

Home Index Icon

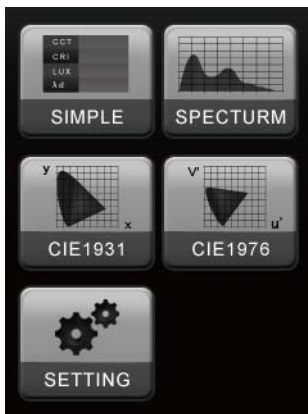

Measurement Mode

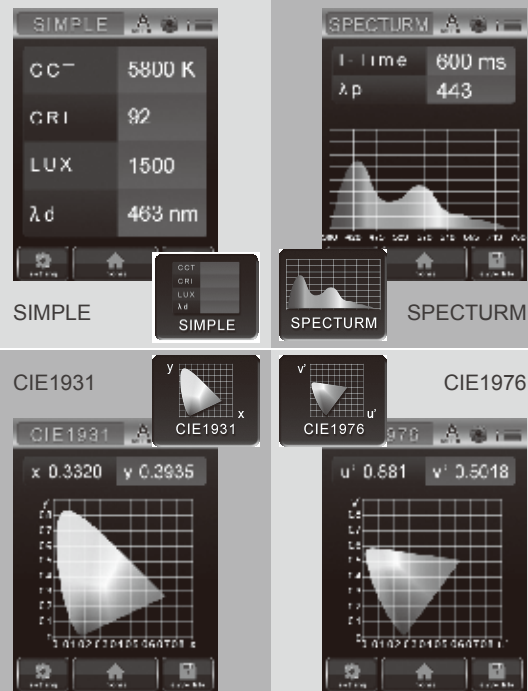

Interface

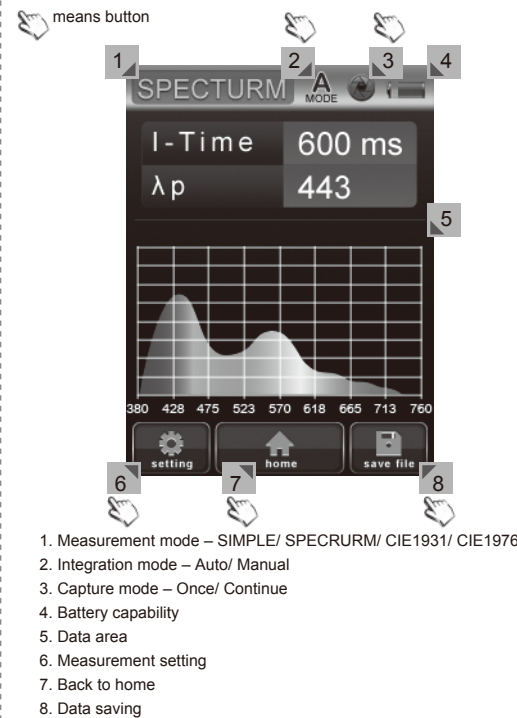

Measurement

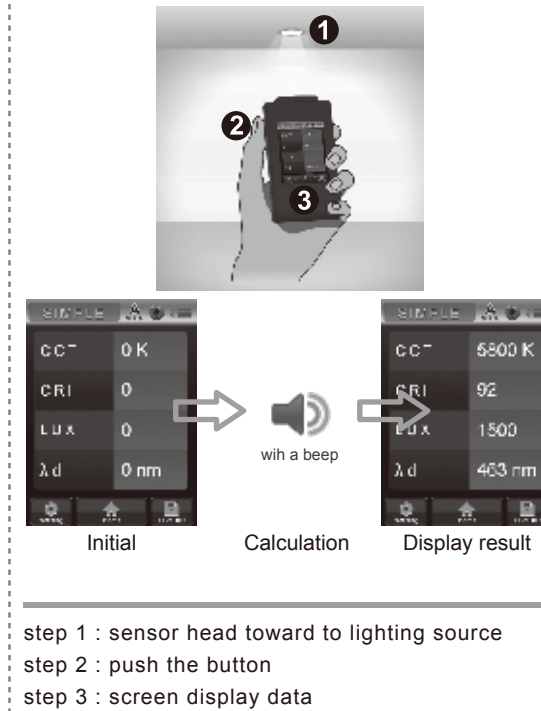

System Setting - 1



Main setting menu

1. Setting list
2. Next page
3. Return
4. Previous page

Submenu setting

5. Setting item
6. Setting content
7. Confirm
8. Deny

System Setting - 2



Measurement Setting - 1

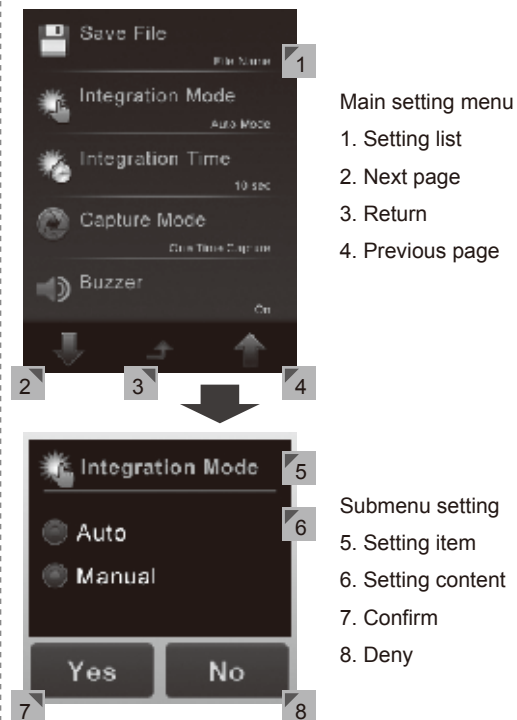

Measurement Setting - 2

